

FOX.4

iotaLAMP

www.iotalamp.com

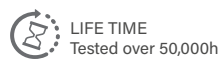
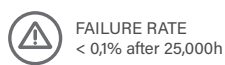

CIRCULAR PROJECTORS
FOX SERIES

References

Code	Type	Finish	Light Color	Power	Lense		Voltage	Driver	
VL-F4	A Base	LG Light grey	White						
	B Base 2	DK Dark grey	W24 2400K	10W	1,5° (10W)	2,5°	UNIV 100-264Vac	STD ON/OFF	
	C Pole Arm	WH White	W27 2700K	15W	6°	12°		010 0-10V	
	D Pole mounted	BK Black	W30 3000K	20W	20°	30°	24 24Vdc	DALI	
	E Stripe mounted	RAL Any RAL color	W40 4000K		40°	60°		CAS Casambi	
	F Nut		W60 6000K		5x20°	10x70°			
	Single Color (SC)								
		R Red			15W	2,5°	6°	UNIV 100-264Vac	STD ON/OFF
		B Blue			20W	12°	20°		010 0-10V
		G Green				30°	40°	24 24Vdc	DALI
		A Amber				60°	5x20°		CAS Casambi
						10x70°	10x70°		
RGBW									
	RGBW3			20W	15°	20°	24 24Vdc	DALI	
	4 in 1 Chip				30°	60°		DMX	
	RGB+W3000K				15x60°			CAS Casambi	
	RGBW4								
	4 in 1 Chip								
	RGB+W4000K								

Reference example

VL-F4-A-WH-W24-10W-1,5°-UNIV-STD

Variations



A
Base



B
Base 2



C
Pole Arm
D=45mm



D
Pole mounted
D67-325mm



E
Stripe mounted



F
Nut (M10x1,5mm)

Dimensions

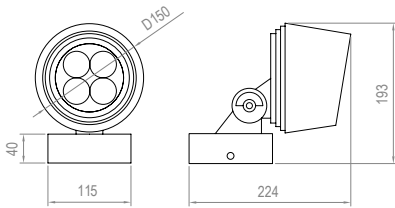

TYPE A

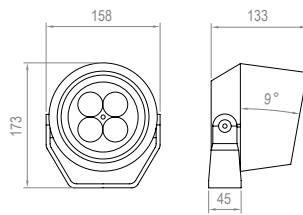

TYPE B

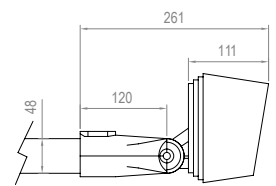

TYPE C

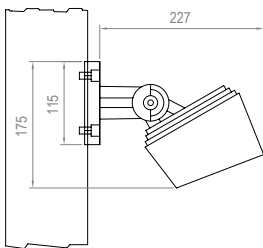

TYPE D

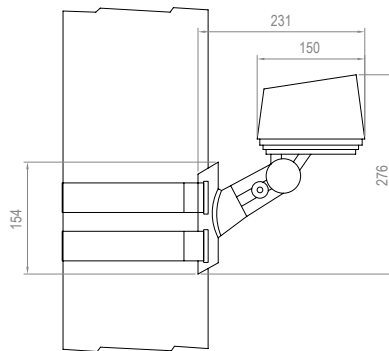

TYPE E

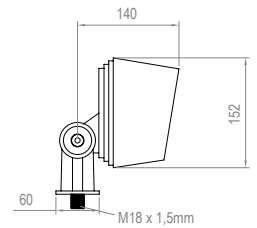

TYPE F

Accessories

Code	Accessories
VL-F4	HC Honeycomb Grid MSH Mesh

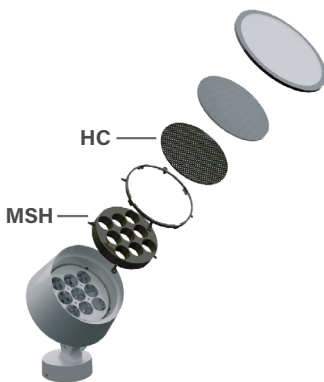

Code	Accessories
VL-F4	*SPK SPIKE *1BR Bracket for 1 projector *2BR Bracket for 2 projector *BX Elevated Box *CBLX Special length cable

* Must be used with Type F
* Must be used with Type C
* Must be used with Type F
* Instead of X, put length of cable needed
Example: VL-F4-CBL-10m



SPK

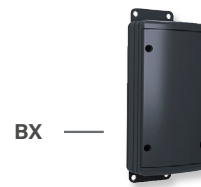

BX

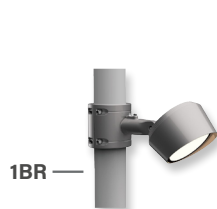
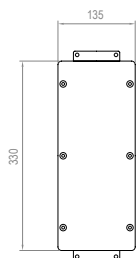

1BR

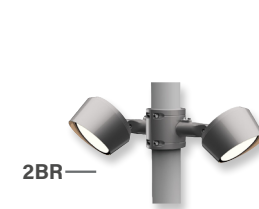
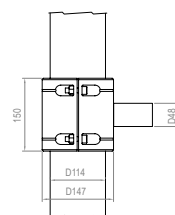

2BR

