

FOX.6

iotaLAMP

www.iotalamp.com

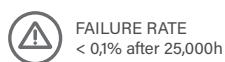

CIRCULAR PROJECTORS
FOX SERIES

References

Code	Type	Finish	Light Color	Power	Lense		Voltage	Driver	
VL-F6	A Base	LG Light grey	White						
	B Base 2	DK Dark grey	W24 2400K	22W	1,5° (22W)	2,5°	UNIV 100-264Vac	STD ON/OFF	
	C Pole Arm	WH White	W27 2700K	30W	6°	12°		010 0-10V	
	D Pole mounted	BK Black	W30 3000K		20°	30°	24 24Vdc	DALI	
	E Stripe mounted	RAL Any RAL color	W40 4000K		40°	60°		CAS Casambi	
	F Nut		W60 6000K		5x20°	10x70°			
	Single Color (SC)								
		R Red			22W	2,5°	6°	UNIV 100-264Vac	STD ON/OFF
		B Blue			30W	12°	20°		010 0-10V
		G Green				30°	40°	24 24Vdc	DALI
		A Amber				60°	5x20°		CAS Casambi
						10x70°	10x70°		
	RGBW								
	RGBW3			30W	8°	15°	UNIV 100-264Vac	DALI	
	4 in 1 Chip			36W	20°	30°		DMX	
	RGB+W3000K				60°	15x60°	24 24Vdc	CAS Casambi	
	RGBW4								
	4 in 1 Chip								
	RGB+W4000K								

Reference example

VL-F6-A-DK-RGBW3-36W-15°-24-DMX

Variations



A
Base



B
Base 2



C
Pole Arm
D=45mm



D
Pole mounted
D67-325mm



E
Stripe mounted



F
Nut (M10x1,5mm)

Dimensions

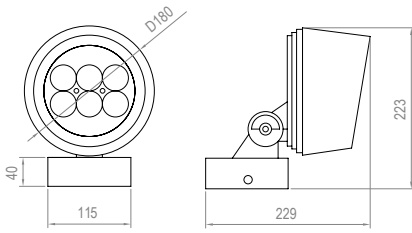

TYPE A

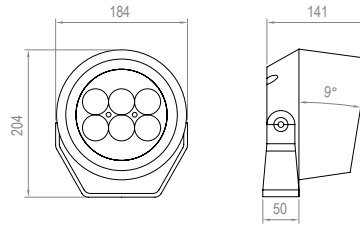

TYPE B

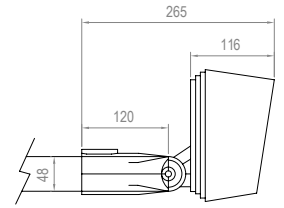

TYPE C

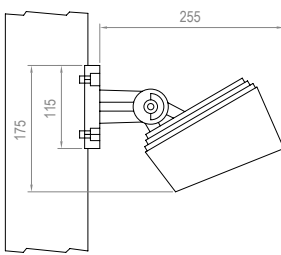

TYPE D

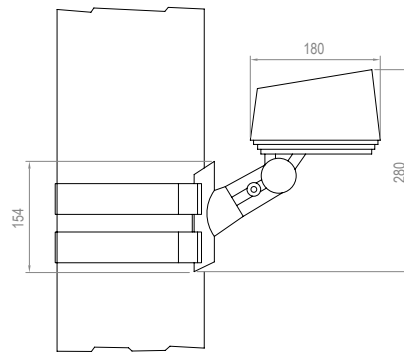

TYPE E

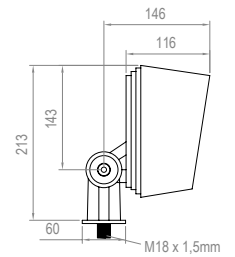

TYPE F

Accessories

Code	Accessories
------	-------------

VL-F6 **HC** Honeycomb Grid
MSH Mesh

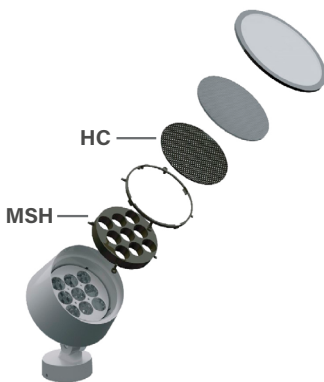

Code	Accessories
------	-------------

VL-F6 ***SPK** SPIKE ** Must be used with Type F*
** Must be used with Type C*
***1BR** Bracket for 1 projector ** Must be used with Type C*
***2BR** Bracket for 2 projector ** Must be used with Type F*
***BX** Elevated Box ** Instead of X, put length of cable needed*
***CBLX** Special length cable *Example: VL-F6-CBL-10m*



SPK

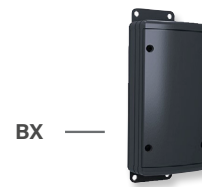
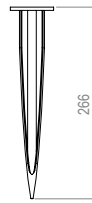

BX

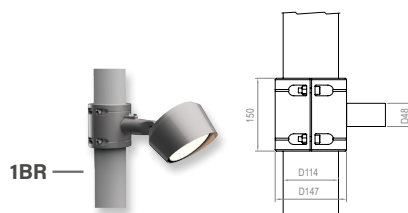
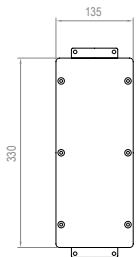

1BR

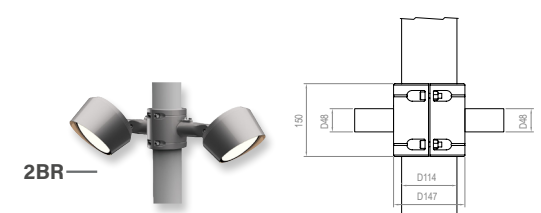

2BR