

IP68 WALLWASHER 6x 2 Watt MONO

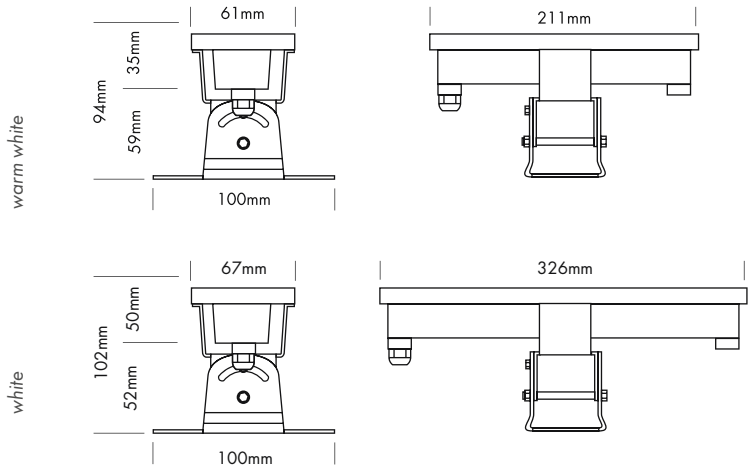

The IP68 WALLWASHER is suitable as underwater spotlight for fountains, ponds, water gardens etc. for atmospheric or underwater lighting.

- dimmable and controllable via DMX 512, DALI, KNX, 1-10 V, CASAMBI, RF by MULTI power supplies or CONTROLLER
- incl. stainless steel tripod

This IP68 luminaire can not be operated out of water for over 15 minutes (cooling).

| Technical Data | |
|------------------------------|---|
| IP classification: | IP68 (for underwater use max. 1 m) |
| Power source: | 24 VDC |
| Housing: | stainless steel 316 5 mm tempered glass |
| Electrical connection: | 1x cable 2 m H05RN-F 2x 1,0 mm ² with 2-PIN IP68 connector male |
| Average lifetime: | 50.000 h at L ₈₀ /B ₁₀ |
| Operating temperature range: | -10° C till +40° C |

| Photometric Data | | |
|---------------------|--------------------------|------------|
| LED type: | OSRAM 1,5 Watt Highpower | |
| Luminous flux: | white | 1100 Lumen |
| | warm white | 1000 Lumen |
| Colour temperature: | white | 5700 K |
| | warm white | 3000 K |
| CRI: | white | 90 |
| | warm white | 80 |
| Beam angle: | 30° | |

Due to conditions of production photometric data can vary from production batch to production batch within the directive.

Product Type

| order code | colour | LED pcs | LED power | Power consumption* | weight | EEC |
|------------|------------|---------|-----------|--------------------|---------|-----|
| 32042G | white | 6 | 12 Watt | 15 Watt | 1,62 kg | E |
| 13206 | warm white | 6 | 9 Watt | 12 Watt | 2,00 kg | F |

Actual power consumption

IP68 SPOT 6x 5 Watt TRILED RGB

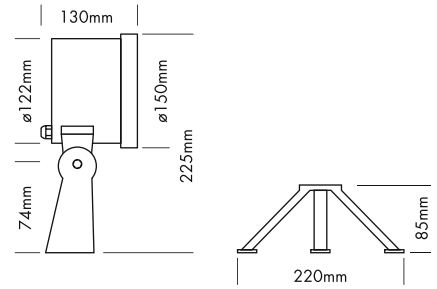

The IP68 SPOT is suitable as underwater spotlight for fountains, ponds, water gardens etc. for atmospheric or underwater lighting.

- dimmable, autom. colour change, controllable via DMX 512, DALI, KNX, 1-10 V, CASAMBI, RF by MULTI power supplies or CONTROLLER
- incl. stainless steel tripod

This IP68 luminaire can not be operated out of water for over 15 minutes (cooling).

Technical Data

| | |
|------------------------------|--|
| IP classification: | IP68 (for underwater use max. 1 m) |
| Power source: | 24 VDC Common Cathode (CC) |
| Housing: | stainless steel 316 13 mm PMMA |
| Electrical connection: | 1x cable 3 m H05RN-F 4x 0,75 mm ² with 4-PIN IP68 connector male |
| Average lifetime: | 50.000 h at L ₈₀ /B ₁₀ |
| Operating temperature range: | -10° C till +40° C |

Photometric Data

| | | |
|----------------|------------------------|------------|
| LED type: | RGB 3-in-1 LEDs 5 Watt | |
| Luminous flux: | red | 400 Lumen |
| | green | 800 Lumen |
| | blue | 140 Lumen |
| | r+g+b (white) | 1200 Lumen |
| Wave length: | red | 620 nm |
| | green | 525 nm |
| | blue | 460 nm |
| Beam angle: | 30° | |

Due to conditions of production photometric data can vary from production batch to production batch within the directive.

Product Type

| order code | colour | LED pcs | LED power | Power consumption* | weight |
|------------|--------|---------|-----------|--------------------|--------|
| 3538U | RGB | 6 | 30 Watt | 39 Watt | 2,5 kg |

*Actual power consumption

REC IP68 LIGHT 1x 3 Watt TRILED RGB

*iota*LAMP™

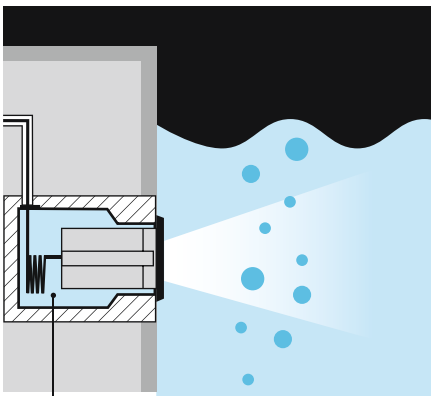

flushed with water
(cooling)

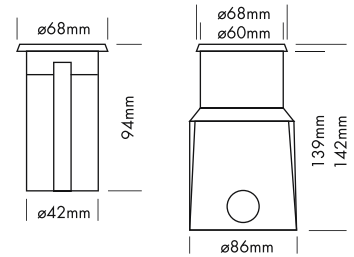

The REC IP68 LIGHT is suitable as underwater spotlight for fountains, pools, ponds, water gardens etc. for atmospheric or underwater lighting.

- dimmable, autom. colour change, controllable via DMX 512, DALI, KNX, 1-10 V, CASAMBI, RF by MULTI power supplies or CONTROLLER
- incl. PVC plastic mounting sleeve
- The mounting sleeve for REC IP68 LIGHT 1x 3 Watt is not waterproof. The sealing must be installed on-site.

This IP68 luminaire can not be operated out of water for over 15 minutes (cooling).

| Technical Data | |
|------------------------------|--|
| IP classification: | IP68 (for underwater use max. 1 m) |
| Power source: | 24 VDC Common Cathode (CC) |
| Housing: | stainless steel 316 7 mm tempered glass |
| Mounting sleeve: | PVC plastic |
| Load capacity: | exert force area of $\varnothing 10 \text{ mm} = 700 \text{ kg}$ |
| Electrical connection: | 1x cable 3 m H05RN-F 4x 0,75 mm ² to open wires |
| Average lifetime: | 50.000 h at L _{80/B10} |
| Operating temperature range: | -10° C till +40° C |

| Photometric Data | |
|------------------|--|
| LED type: | RGB 3-in-1 LED 3 Watt |
| Luminous flux: | red 40 Lumen green 80 Lumen blue 15 Lumen r+g+b (white) 130 Lumen |
| Wave length: | red 620 nm green 525 nm blue 460 nm |
| Beam angle: | 25° |

Due to conditions of production photometric data can vary from production batch to production batch within the EU directive.

Product Type

| order code | colour | LED pcs | LED power | Power consumption* | weight |
|------------|--------|---------|-----------|--------------------|--------|
| 3618 | RGB | 1 | 3 Watt | 4 Watt | 0,7 kg |

*Actual power consumption

REC IP68 LIGHT 1x 3 Watt MONO

*iota*LAMP™



Asymmetrische Linse 45°/35° / Asymmetrical lens 45°/35°

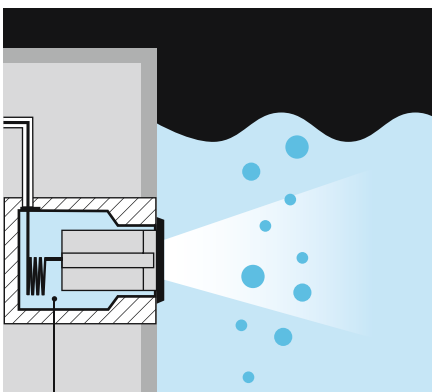

flushed with water (cooling)

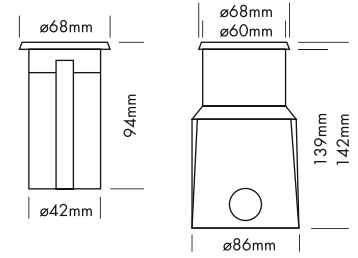

The REC IP68 LIGHT is suitable as underwater spotlight for fountains, pools, ponds, water gardens etc. for atmospheric or underwater lighting.

- dimmable and controllable via DMX 512, DALI, KNX, 1-10 V, CASAMBI, RF by MULTI power supplies or CONTROLLER
- incl. PVC plastic mounting sleeve
- The mounting sleeve for REC IP68 LIGHT 1x 3 Watt is not waterproof. The sealing must be installed on-site.

This IP68 luminaire can not be operated out of water for over 15 minutes (cooling).

| Technical Data | |
|------------------------------|--|
| IP classification: | IP68 (for underwater use max. 1 m) |
| Power source: | 24 VDC |
| Housing: | stainless steel 316 7 mm tempered glass |
| Mounting sleeve: | PVC plastic |
| Load capacity: | exert force area of $\varnothing 10 \text{ mm} = 700 \text{ kg}$ |
| Electrical connection: | 1x cable 3 m H07RN-F 2x 1,0 mm ² to open wires |
| Average lifetime: | 50.000 h at L80/B10 |
| Operating temperature range: | -10° C till +40° C |

| Photometric Data | |
|---------------------|--|
| LED type: | OSRAM 3 Watt high power |
| Luminous flux: | white 240 Lumen warm white 170 Lumen |
| Colour temperature: | white 5700 K warm white 3000 K |
| CRI: | white 70 warm white 80 |
| Beam angle: | 15° (only white), 30° and asymmetrical 45°/35° |

Due to conditions of production photometric data can vary from production batch to production batch within the directive.

Product Type

| order code | colour | beam angle | LED pcs | LED power | Power consumption* | weight | EEC |
|------------|------------|---------------|---------|-----------|--------------------|--------|-----|
| 3611 | white | 15° | 1 | 3 Watt | 3 Watt | 0,7 kg | D |
| 3613 | white | 30° | 1 | 3 Watt | 3 Watt | 0,7 kg | D |
| 361A | white | asym. 45°/35° | 1 | 3 Watt | 3 Watt | 0,7 kg | D |
| 3613 | warm white | 30° | 1 | 3 Watt | 3 Watt | 0,7 kg | E |
| 361A | warm white | asym. 45°/35° | 1 | 3 Watt | 3 Watt | 0,7 kg | E |

* Actual power consumption

REC IP68 LIGHT 12x 2 Watt TRILED RGB

*iota*LAMP™

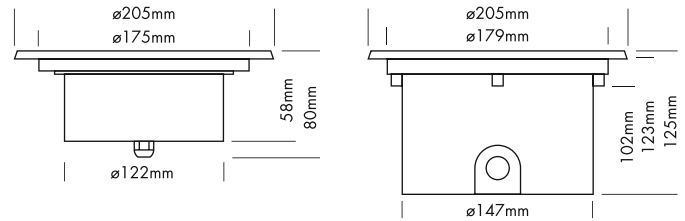
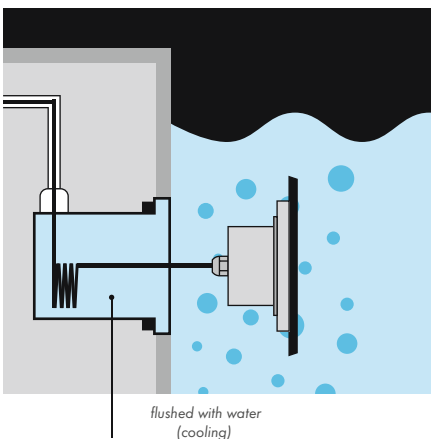

The REC IP68 LIGHT is suitable as underwater spotlight for fountains, pools, ponds, water gardens etc. for atmospheric or underwater lighting.

- dimmable, autom. colour change, controllable via DMX 512, DALI, KNX, 1-10 V, CASAMBI, RF by MULTI power supplies or CONTROLLER
- incl. PVC plastic mounting sleeve
- The mounting sleeve for REC IP68 LIGHT 12x 2 Watt is IP68. It seals towards the wall it is installed in.

This IP68 luminaire can not be operated out of water for over 15 minutes (cooling).

| Technical Data | |
|------------------------------|--|
| IP classification: | IP68 (for underwater use max. 1 m) |
| Power source: | 24 VDC Common Cathode (CC) |
| Housing: | stainless steel 316 10 mm tempered glass |
| Mounting sleeve: | PVC plastic |
| Load capacity: | exert force area of $\varnothing 10$ mm = 700 kg, $\varnothing 30$ mm = 900 kg, $\varnothing 60$ mm = 1500 kg |
| Electrical connection: | 1x cable 3 m H05RN-F 4x 1,0 mm ² to open wires |
| Average lifetime: | 50.000 h at L80/B10 |
| Operating temperature range: | -10° C till +40° C |

| Photometric Data | |
|------------------|--|
| LED type: | RGB 3-in-1 LEDs 2 Watt |
| Luminous flux: | red 300 Lumen green 750 Lumen blue 250 Lumen r+g+b (white) 1300 Lumen |
| Wave length: | red 620 nm green 525 nm blue 460 nm |
| Beam angle: | 25° |

Due to conditions of production photometric data can vary from production batch to production batch within the EU directive.

Product Type

| order code | colour | LED pcs | LED power | Power consumption* | weight |
|------------|--------|---------|-----------|--------------------|--------|
| 3638 | RGB | 12 | 24 Watt | 35 Watt | 2,1 kg |

*Actual power consumption

REC IP68 LIGHT 12x 2 Watt MONO

*iota*LAMP™

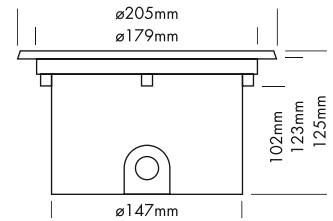
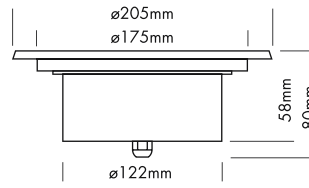

The REC IP68 LIGHT is suitable as underwater spotlight for fountains, pools, ponds, water gardens etc. for atmospheric or underwater lighting.

MULTI power supplies or CONTROLLER

- dimmable and controllable via DMX 512, DALI, KNX, 1-10 V, CASAMBI, RF by

- incl. PVC plastic mounting sleeve
- The mounting sleeve for REC IP68 LIGHT 12x 2 Watt is IP68. It seals towards the wall it is installed in.

This IP68 luminaire can not be operated out of water for over 15 minutes (cooling).

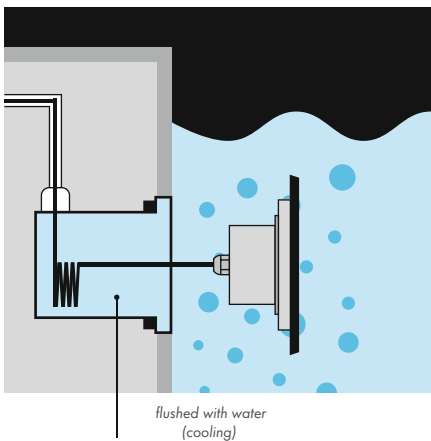

| Technical Data | |
|------------------------------|--|
| IP classification: | IP68 (for underwater use max. 1 m) |
| Power source: | 24 VDC |
| Housing: | stainless steel 316 10 mm tempered glass |
| Mounting sleeve: | PVC plastic |
| Load capacity: | exert force area of ø10 mm = 700 kg, ø30 mm = 900 kg, ø60 mm = 1.500 kg |
| Electrical connection: | 1x cable 3 m H05RN-F 2x 1,0 mm ² to open wires |
| Average lifetime: | 50.000 h at L80/B10 |
| Operating temperature range: | -10° C till +40° C |

| Photometric Data | |
|---------------------|-------------------------|
| LED type: | OSRAM 2 Watt high power |
| Luminous flux: | white 1800 Lumen |
| | warm white 3000 Lumen |
| Colour temperature: | white 5700 K |
| | warm white 3000 K |
| CRI: | white 70 |
| | warm white 80 |
| Beam angle: | 25° |

Due to conditions of production photometric data can vary from production batch to production batch within the directive.

Product Type

| order code | colour | LED pcs | LED power | Power consumption* | weight | EEC |
|------------|------------|---------|-----------|--------------------|--------|-----|
| 36342 | white | 12 | 24 Watt | 31 Watt | 2,1 kg | G |
| 36362 | warm white | 12 | 24 Watt | 28 Watt | 2,1 kg | E |

* Actual power consumption

REC IP68 LIGHT 18x 2 Watt TRILED RGB

*iota*LAMP™

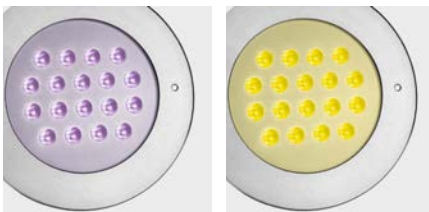
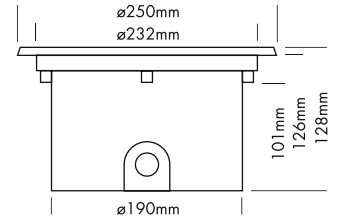
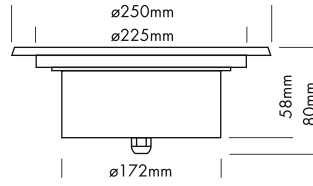

The PRO REC IP68 LIGHT is suitable as underwater spotlight for fountains, pools, ponds, water gardens etc. for atmospheric or underwater lighting.

- dimmable, autom. colour change, controllable via DMX 512, DALI, KNX, 1-10 V, CASAMBI, RF by MULTI power supplies or PRO CONTROLLER
- incl. PVC plastic mounting sleeve
- The mounting sleeve for REC IP68 LIGHT 18x 2 Watt is IP68. It seals towards the wall it is installed in.

This IP68 luminaire can not be operated out of water for over 15 minutes (cooling).

3.6

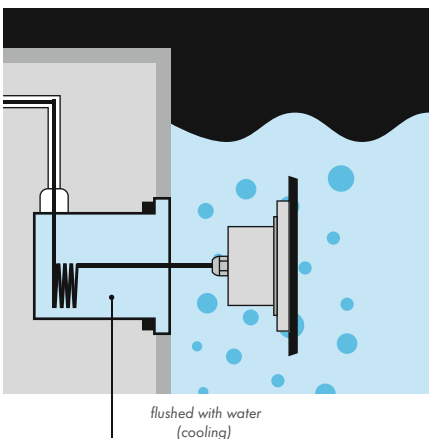

Technical Data

| | |
|------------------------------|--|
| IP classification: | IP68 (for underwater use max. 1 m) |
| Power source: | 24 VDC Common Cathode (CC) |
| Housing: | stainless steel 316 10 mm tempered glass |
| Mounting sleeve: | PVC plastic |
| Load capacity: | exert force area of $\varnothing 10\text{ mm} = 700\text{ kg}$, $\varnothing 30\text{ mm} = 900\text{ kg}$, $\varnothing 60\text{ mm} = 1500\text{ kg}$ |
| Electrical connection: | 1x cable 3 m H05RN-F 4x 1,0 mm ² to open wires |
| Average lifetime: | 50.000 h at L80/B10 |
| Operating temperature range: | -10° C till +40° C |

Photometric Data

| | | |
|----------------|------------------------|------------|
| LED type: | RGB 3-in-1 LEDs 2 Watt | |
| Luminous flux: | red | 400 Lumen |
| | green | 920 Lumen |
| | blue | 260 Lumen |
| | r+g+b (white) | 1580 Lumen |
| Wave length: | red | 620 nm |
| | green | 525 nm |
| | blue | 460 nm |
| Beam angle: | 25° | |

Due to conditions of production photometric data can vary from production batch to production batch within the EU directive.

Product Type

| order code | colour | LED pcs | LED power | Power consumption* | weight |
|------------|--------|---------|-----------|--------------------|--------|
| 3648 | RGB | 18 | 36 Watt | 53 Watt | 3,8 kg |

*Actual power consumption

REC IP68 LIGHT 18x 2 Watt MONO

*iota*LAMP™

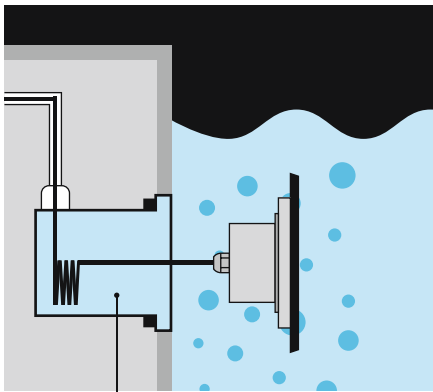
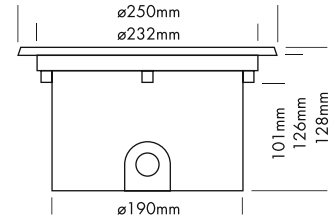
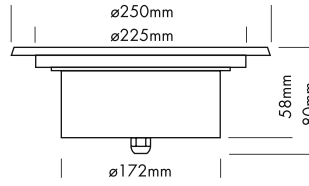

flushed with water (cooling)

The LED REC IP68 LIGHT is suitable as underwater spotlight for fountains, pools, ponds, water gardens etc. for atmospheric or underwater lighting.

- dimmable and controllable via DMX 512, DALI, KNX, 1-10 V, CASAMBI, RF by MULTI power supplies or PRO CONTROLLER
- incl. PVC plastic mounting sleeve
- The mounting sleeve for REC IP68 LIGHT 18x 2 Watt is IP68. It seals towards the wall it is installed in.

This IP68 luminaire can not be operated out of water for over 15 minutes (cooling).

Technical Data

| | |
|------------------------------|--|
| IP classification: | IP68 (for underwater use max. 1 m) |
| Power source: | 24 VDC |
| Housing: | stainless steel 316 10 mm tempered glass |
| Mounting sleeve: | PVC plastic |
| Load capacity: | exert force area of $\varnothing 10 \text{ mm} = 700 \text{ kg}$, $\varnothing 30 \text{ mm} = 900 \text{ kg}$, $\varnothing 60 \text{ mm} = 1500 \text{ kg}$ |
| Electrical connection: | 1x cable 3 m H07RNF 2x 1,0 mm ² to open wires |
| Average lifetime: | 50.000 h at L ₅₀ /B10 |
| Operating temperature range: | -10° C till +40° C |

Photometric Data

| | | |
|---------------------|-------------------------|------------|
| LED type: | OSRAM 2 Watt high power | |
| Luminous flux: | white | 3000 Lumen |
| | warm white | 2300 Lumen |
| Colour temperature: | white | 5700 K |
| | warm white | 3000 K |
| CRI: | white | 70 |
| | warm white | 80 |
| Beam angle: | 20° and 45° | |

Due to conditions of production photometric data can vary from production batch to production batch within the EU directive.

Product Type

| order code | colour | beam angle | LED pcs | LED power | Power consumption* | weight | EEC |
|------------|---------------------|------------|---------|-----------|--------------------|--------|-----|
| 36442 | white | 20° | 18 | 36 Watt | 48 Watt | 3,6 kg | G |
| 36462 | warm white | 20° | 18 | 36 Watt | 48 Watt | 3,6 kg | G |
| 36464 | warm white * Actual | 45° | 18 | 36 Watt | 48 Watt | 3,6 kg | G |

power consumption

ACCESSORIES FOR REC IP68 LIGHTS 1x 3 W

iotaLAMP™

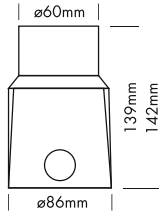

MOUNTING SLEEVE

The mounting sleeve for REC IP68 LIGHT 1x 3 Watt is not waterproof. The sealing must be installed on-site.

| order code | description |
|------------|-----------------------------|
| 361U | PVC plastic mounting sleeve |

ACCESSORIES FOR REC IP68 LIGHTS 12x 2 W

iotaLAMP™

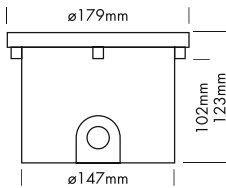

MOUNTING SLEEVE

The mounting sleeve for REC IP68 LIGHT 12x 2 Watt is IP68. It seals towards the wall it is installed in.

| order code | description |
|------------|-----------------------------|
| 363T | PVC plastic mounting sleeve |

ACCESSORIES FOR REC IP68 LIGHTS 18x 2 W

iotaLAMP™

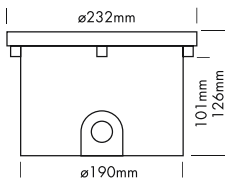

MOUNTING SLEEVE

The mounting sleeve for REC IP68 LIGHT 18x 2 Watt is IP68. It seals towards the wall it is installed in.

| order code | description |
|------------|-----------------------------|
| L1364T | PVC plastic mounting sleeve |

FOUNTAIN RING 9x 2 Watt TRILED RGB

*iota*LAMP™

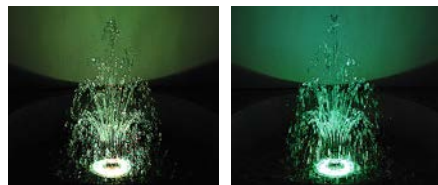
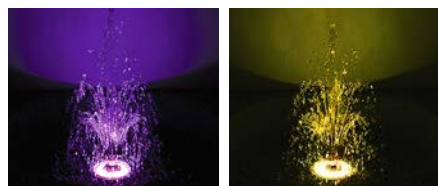
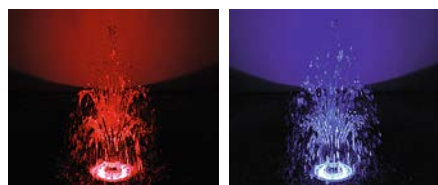
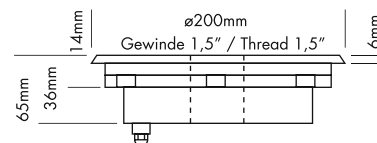

The LED FOUNTAIN RING is conceived for underwater illumination of fountains and water gardens. ■

dimable, autom. colour change, controllable via DMX 512, DALI, KNX, 1-10 V, CASAMBI, RF by MULTI power supplies or CONTROLLER

This IP68 luminaire can not be operated out of water for over 15 minutes (cooling).

| Technical Data | |
|------------------------------|---|
| IP classification: | IP68 (for underwater use max. 1 m) |
| Power source: | 24 VDC Common Cathode (CC) |
| Housing: | stainless steel 316 5 mm tempered glass |
| Electrical connection: | 1x cable 3 m H07RN-F 4x 1,0 mm ² with 4-PIN IP68 connector male |
| Average lifetime: | 50.000 h at L80/B10 |
| Operating temperature range: | -10° C till +40° C |

| Photometric Data | |
|------------------|---|
| LED type: | RGB 3-in-1 LEDs |
| Luminous flux: | red 220 Lumen green 550 Lumen blue 180 Lumen r+g+b (white) 950 Lumen |
| Wave length: | red 620 nm green 525 nm blue 460 nm |
| Beam angle: | 25° |

Due to conditions of production photometric data can vary from production batch to production batch within the directive.

Product Type

| order code | colour | LED pcs | LED power | Power consumption* | weight |
|------------|--------|---------|-----------|--------------------|--------|
| 340 | RGB | 9 | 18 Watt | 28 Watt | 2,7 kg |

* Actual power consumption

FOUNTAIN RING 9x 2 Watt MONO / 12x 2 Watt MONO

iotaLAMP™

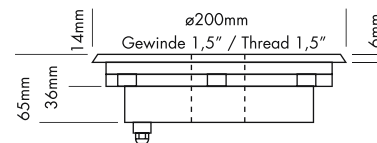

The PROLED FOUNTAIN RING is conceived for underwater illumination of fountains and water gardens.

- dimmable and controllable via DMX 512, DALI, KNX, 1-10 V, CASAMBI, RF by MULTI power supplies or PRO CONTROLLER

This IP68 luminaire can not be operated out of water for over 15 minutes (cooling).

| Technical Data | |
|------------------------------|---|
| IP classification: | IP68 (for underwater use max. 1 m) |
| Power source: | 24 VDC |
| Housing: | stainless steel 316 10 mm tempered glass |
| Electrical connection: | 1x cable 3 m H05RN-F 2x 1,0 mm ² with 2-PIN IP68 connector male |
| Average lifetime: | 50.000 h at L _{80/B10} |
| Operating temperature range: | -10° C till +40° C |

| Photometric Data | |
|---------------------|---|
| LED type: | OSRAM 2 Watt high power |
| Luminous flux: | white 1900 Lumen warm white 2000 Lumen |
| Colour temperature: | white 6500 K warm white 3000 K |
| CRI: | white 70 warm white 80 |
| Beam angle: | 25° |

Due to conditions of production photometric data can vary from production batch to production batch within the directive.

Product Type

| order code | colour | LED pcs | LED power | Power consumption* | weight | EEC |
|------------|------------|---------|-----------|--------------------|--------|-----|
| 462G | warm white | 9 | 18 Watt | 24 Watt | 2,8 kg | E |
| 344 | white | 12 | 24 Watt | 30 Watt | 2,8 kg | E |

*Actual power consumption